



Engine Control Lever & Cables Fittings

Fittings



Ball Joint

Part Number	A	B
BJ-30	No. 10-32 UNF	M6 × 1.0
BJ-31	No. 10-32 UNF	M8 × 1.25
BJ-33	No. 10-32 UNF	No. 5/16-24 UNF
BJ-34	M5 × 0.8	M6 × 1.0
BJ-35	M6 × 1.0	M6 × 1.0

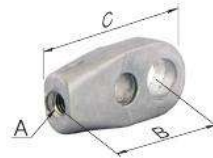

SB-129

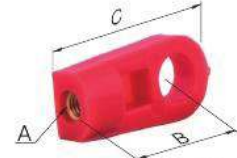

ST-9567

Terminal Eye

Part Number	A	B	C
SB-129	No. 10-32 UNF	25.0	32.4
ST-9567	No. 10-32 UNF	24.5	32.1

13



SB-132
ST-9565

Clamp

Part Number	A	B	C	D	E	F
SB-132	10.0	26.0	40.7	13.0	10.4	5.2×7.8
ST-9565	10.0	21.0	31.1	13.0	10.2	∅5.5

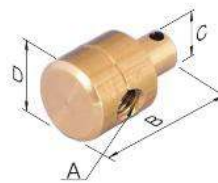

AB-146

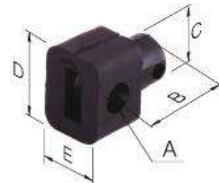

ST-9566

Pivot (For Lever)

Part Number	A	B	C	D	E
AB-146	No. 10-32 UNF	19.5	∅6.0	∅12.0	-
ST-9566	∅4.8	17.0	∅7.9	13.9	10.8



SB-131

Shim

Part Number	A	B	C	D	E	F
SB-131	20.7	28.5	42.0	12.0	3.0	5.2×7.8

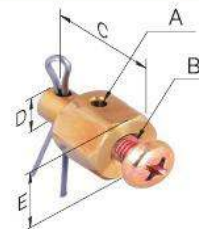

AB-147

Pivot (For B14 Cable)

Part Number	A	B	C	D	E
AB-147	∅2.4	M5×10	17.0	∅5.9	11.0



ST-9607-1



ST-9607-2

Knob (For ST-Single, ST-Twin Lever)

Part Number	Color	Size
ST-9607-1	Mixed Red	∅38
ST-9607-2	Black	∅38



ST-9561-1

ST-9561-2

Flat Spring (For ST-Type Lever)

Part Number	A	B	Thickness
ST-9561-1	75.4	8.0	0.4
ST-9561-2	75.4	8.0	0.8



Selector Unit

DS-100

듀얼 스테이션 적용을 위한 셀렉터 유닛

- 셀렉터 유닛은 듀얼 스테이션 적용시 싱글 레버 컨트롤과 함께 사용된다.
- 이것은 메인 스테이션 및 플라잉 브릿지 스테이션에서 독립적인 스로틀 및 클러치 컨트롤을 가능하게 한다.

NOTE : 스테이션을 변경하기 전에 스로틀은 반드시 공회전 위치에 있어야 하며, 클러치는 중립이어야 한다.

Selector Unit for Dual Station Application

- When selector unit is applied with dual station, single lever control is used along.
- It enables independent control over throttle and clutch from either main station or fly bridge station.

NOTE : Before changing the station, throttle must be at idling position and clutch at neutral state.

DS-100 (Application : Dual Station)

14

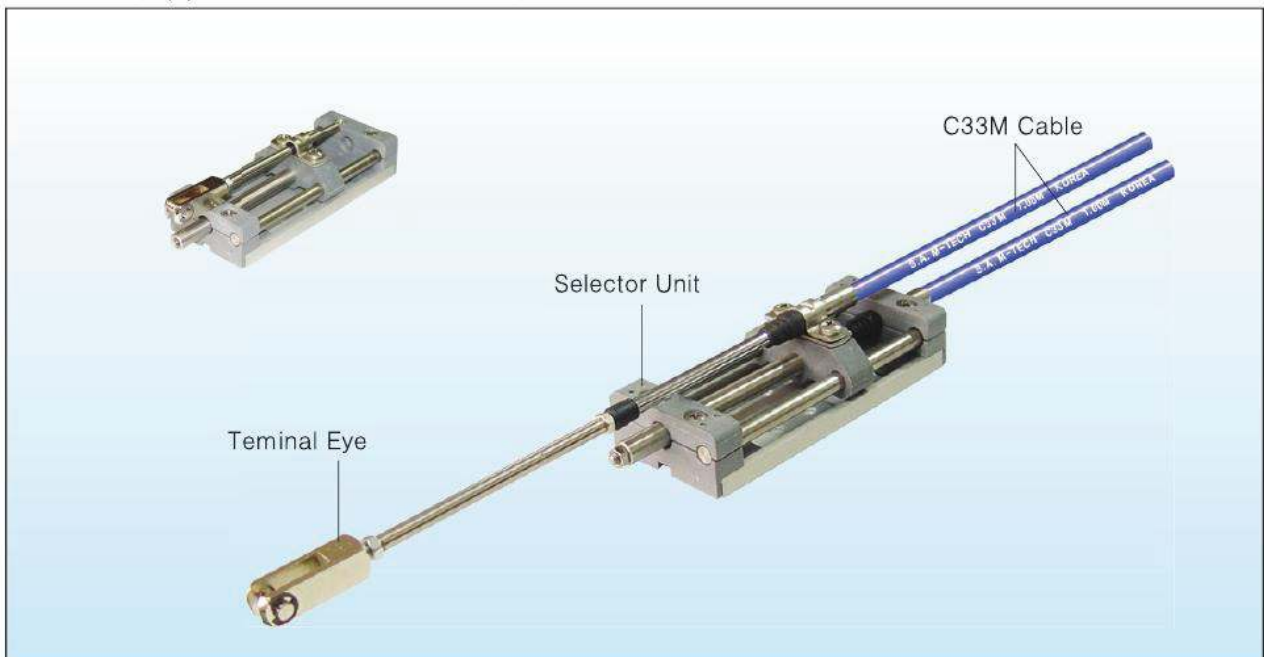

DS-100 선택 장치 응용 (Applications)

